

LBH型

防塵密封件

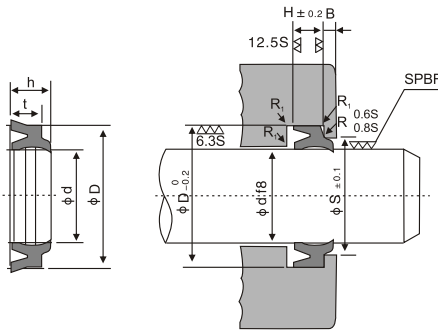

R ≤ 0.3
R1 ≤ 0.5

活塞杆表面應當拋光(SPBF)或(RLB)到0.8-1.6 μmRmax (0.2~0.4 μmRa), 特別是在惡劣的潤滑條件下, 更需要拋光。

名義號	φd	φD	t	h	φs	H	B	KVK零件號	KVK單價¥	NOK零件號	NOK單價¥
LBH-6	6	10	3	4.2	7.3	3.4	2	CL2324C0	3.8		
LBH-11.2	11.2	19.2	4.5	6	15.5	5	2	CL2308C0	3.8		
LBH-12	12	20	4.5	6	16.3	5	2	CL2309C0	3.8	CL0480C0	9.04
LBH-12A	12	16	3.5	5	14.3	4	2	CL2325C0	5		
LBH-12B	12	18	3.5	4.8	15.8	4	2	CL2330C0	5		
LBH-12C	12	20	5	7	16.3	6	2	CL2337C0	5		
LBH-12.5	12.5	20.5	4.5	6	16.8	5	2	CL2310C0	3.8	CL0447C1	9.04
LBH-14	14	22	4.5	6	18.3	5	2	CL2311C0	3.8	CL0432C0	8.24
LBH-15A	15	21	4.5	6	18.3	5	2	CL2339C0	3.8		
LBH-16	16	24	4.5	6	20.3	5	2	CL2312C0	3.8	CL0293C0	8.72
LBH-17	17	22	3.5	4.9					5.7		
LBH-18	18	26	4.5	6	22.3	5	2	CL2313C0	3.8	CL0011C0	8.72
LBH-20	20	28	4.5	6	24.3	5	2	CL2314C0	3.8	CL0017C0	8.72
LBH-22	22	30	4.5	6	26.3	5	2	CL2315C0	3.9	CL0240C0	8.72
LBH-22A	22	28	3.6	4.8	24.5	4	2	CL2340C0	5		
LBH-22B	22	28	6	6.7	24.5	7	2	CL2341C0	5		
LBH-22.4	22.4	30.4	4.5	6	26.7	5	2	CL3018R2	3.9	CL0026C3	8.72
LBH-23.5	23.5	31.5	4.5	6	27.8	5	2	CL3018R0	3.9		
LBH-25	25	33	4.5	6	29.3	5	2	CL2318C0	3.9	CL0031C0	8.72
LBH-26	26	34	4.5	6	30.3	5	2	CL2319C0	3.9		
LBH-28	28	36	4.5	6	32.3	5	2	CL2320C0	3.9	CL0042C0	8.72
LBH-30	30	38	5	6.5	34	6	2	CL2321C0	4.8	CL0050C0	8.72
LBH-31.5	31.5	39.5	5	6.5	35.5	6	2	CL2322C0	4.8	CL0054C0	8.72
LBH-32	32	40	5	6.5	36	6	2	CL2323C0	4.8	CL0363C0	8.72
LBH-34	34	42	5	6.5	38	6	2	CL3151R4	4.8		
LBH-35	35	43	5	6.5	39	6	2	CL215R3A	5.3	CL0066C1	9.04
LBH-35.5	35.5	43.5	5	6.5	39.5	6	2	CL2326C0	5.3	CL0072C0	9.04
LBH-36	36	44	5	6.5	40	6	2	CL0360C0	5.3	CL0335C1	9.04
LBH-38	38	46	5	6.5	42	6	2	CL2327C0	5.3		
LBH-40	40	48	5	6.5	44	6	2	CL2328C0	5.3	CL0077C2	9.68
LBH-45	45	53	5	6.5	49	6	2	CL2329C0	5.6	CL0085C0	11.10
LBH-45A	45	55	6	9	49.5	7	2	CL2342C0	7		
LBH-48	48	56	5	6.5	52	6	2	CL2816C0	5.6		
LBH-50	50	58	5	6.5	54	6	2	CL2331C0	5.6	CL0087C3	12.22
LBH-50A	50	58.6	5.3	7	54	6.3	2	CL2343C0	7.5		
LBH-50B	50	60	5.5	7	54.5	6.5	2	CL2344C0	7.5		

名義號	φd	φD	t	h	φs	H	B	KVK零件號	KVK 單價 ¥	NOK零件號	NOK 單價 ¥
LBH-53	53	61	5	6.5	57	6	2	CL2332C0	8.4	CL0100C0	13.18
LBH-55	55	63	5	6.5	59	6	2	CL2333C0	8.4	CL0104C0	13.18
LBH-56	56	64	5	6.5	60	6	2	CL2334C0	8.4	CL0105C1	13.18
LBH-58	58	66	5	6.5	62	6	2	CL2335C0	8.7		
LBH-60	60	68	5	6.5	64	6	2	CL2336C0	8.7	CL0107C0	13.96
LBH-63	63	71	5	6.5	67	6	2	CL0635C1	9.2	CL0109C1	14.92
LBH-65	65	73	5	6.5	69	6	2	CL0636C0	9.2	CL0115C0	14.92
LBH-67	67	75	5	6.5	71	6	2	CL0536C2	9.2	CL0118C1	16.82
LBH-70	70	80	6	8	75	7	3	CL0423C0	11.5	CL0121C0	16.04
LBH-71	71	81	6	8	76	7	3	CL0325C2	11.5	CL0125C0	16.04
LBH-75	75	85	6	8	80	7	3	CL1303C0	12	CL0127C0	17.32
LBH-80	80	90	6	8	85	7	3	CL2037C2	13	CL0138C1	18.42
LBH-85	85	95	6	8	90	7	3	CL2047C2	13.5	CL0142C0	20.64
LBH-90	90	100	6	8	95	7	3	CL2053C1	13.5	CL0149C0	20.64
LBH-95	95	105	6	8	100	7	3	CL2063C2	17	CL0152C0	21.90
LBH-98	98	108	6	8	103	7	3	CL2137U2	17.5		
LBH-100	100	110	6	8	105	7	3	CL2073C2	20.5	CL0154C2	22.70
LBH-105	105	115	6	8	110	7	3	CL2052C1	21	CL0476C0	27.94
LBH-106	106	116	6	8	111	7	3	CL1060C0	21	CL0162C0	27.94
LBH-110	110	120	6	8	115	7	3	CL2053C2	21	CL0448C0	30.96
LBH-112	112	122	6	8	117	7	3	CL2056C0	22	CL0166C2	27.94
LBH-115	115	125	6	8	120	7	3	CL2057C3	26.5	CL0478C0	32.86
LBH-118	118	128	6	8	123	7	3	CL1180C0	26.5	CL0466C0	34.46
LBH-120	120	130	7	9.5	125	8	3	CL2032C0	26.5		
LBH-120	120	133	7	9.5	127	8	3			CL0466C0	35.56
LBH-120A	120	135	7	9.5	127	8	3	CL203AC0	26.5		
LBH-125	125	138	7	9.5	132	8	3	CL3068C0	28.5	CL0171C0	36.36
LBH-128	128	140	7	9					45		
LBH-130	130	143	7	9.5	137	8	3	CL1300C0	29.5		
LBH-132	132	145	7	9.5	139	8	3	CL1320C0	29.5	CL0174C0	43.18
LBH-136	136	149	7	9.5	143	8	3	CL3056C0	29.5		
LBH-140	140	153	7	9.5	147	8	3	CL3075C0	29.5	CL0179C1	45.72
LBH-145	145	158	7	9.5	152	8	3	CL0812C0	30	CL0182C0	48.74
LBH-150	150	163	7	9.5	157	8	3	CL0806C0	31	CL0185C0	51.44
LBH-153	153	165	6.5	9	160	7.5	3	CL1530C0	30		
LBH-155	155	167	7	9.5	162	8	3	CL1550C0	32	CL0486C0	54.60
LBH-160	160	173	7	9.5	167	8	3	CL0866C0	32	CL0188C1	57.16
LBH-160A	160	174	7	9.5	167	8	3	CL160AC0	32	CL0487C0	57.16
LBH-165	165	178	7	9.5	172	8	3	CL0868C0	32	CL0190C0	60.18
LBH-170	170	183	7	9.5	177	8	3	CL170AC0	48	CL0488C0	68.26
LBH-170A	170	185	11	14	178	12	5			CL0191C0	73.98
LBH-175	175	188	7	9.5	182	8	3	CL175AC0	49	CL0193C0	73.98
LBH-180	180	193	7	9.5	187	8	3	CL0968C0	49	CL0196C1	67
LBH-180A	180	194	7	9.5	187	8	3	CL180AC0	53	CL0489C0	67
LBH-190	190	203	7	9.5	197	8	3	CL190AC0	53	CL0490C0	76.20
LBH-200	200	213	7	9.5	207	8	3	CL13A680	53	CL0199C1	86.68
LBH-200A	200	213	7.5	9.5	207	8.5	3	CL200AC0	61		
LBH-200B	200	213	8	9.5	207	9	3	CL200BC0	61		
LBH-204	204	217	7	9.5	211	8	3	CL1637C0	61		
LBH-205	205	218	7	9.5	212	8	3	CL205AC0	64	CL0446C0	92.40

